

PARKING INSTRUCTIONS AND MAPS

Parking for Gloria Molina Grand Park is available in Lot 10 on N. Broadway between First Street and Temple Street. The parking lot address is 145 N. Broadway with entrances on Broadway and on Hill St. The parking rate is \$10.00 per day on weekends.

Lot 10 does not open on Sundays until 9:00 a.m. After you have parked you will see signs for an elevator and a stairway to Grand Park. However, the elevator is not in operation and the stairway is blocked off on Sundays for security reasons. You should exit the parking lot where the cars exit the lot. Turn right and walk up to Hill Street and turn right. Cross Hill Street to the Performance Lawn (green dots)

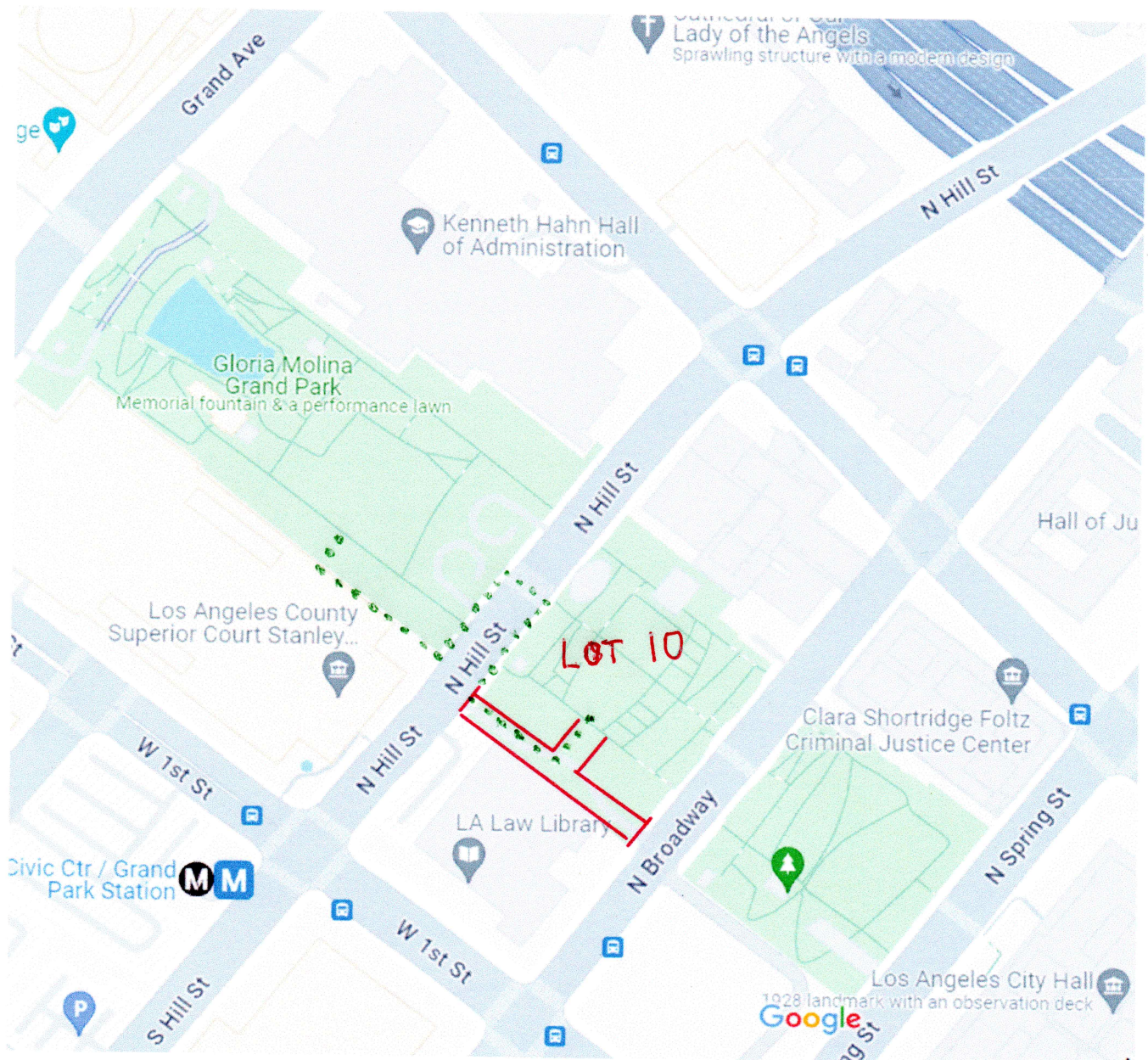

PARKING INSTRUCTIONS AND MAPS

101 Judge John Aiso Street. Entrance is on the West side of the street, between Temple and First Street. Parking rate is \$1.00 per hour for the first two hours; \$3.00 for the third hour; \$1.50 each 15 minutes thereafter with a \$14.00 daily maximum.

124 Judge John Aiso Street. Entrance is on the East side of the Street between Temple and First Street. \$7.00 Flat rate.

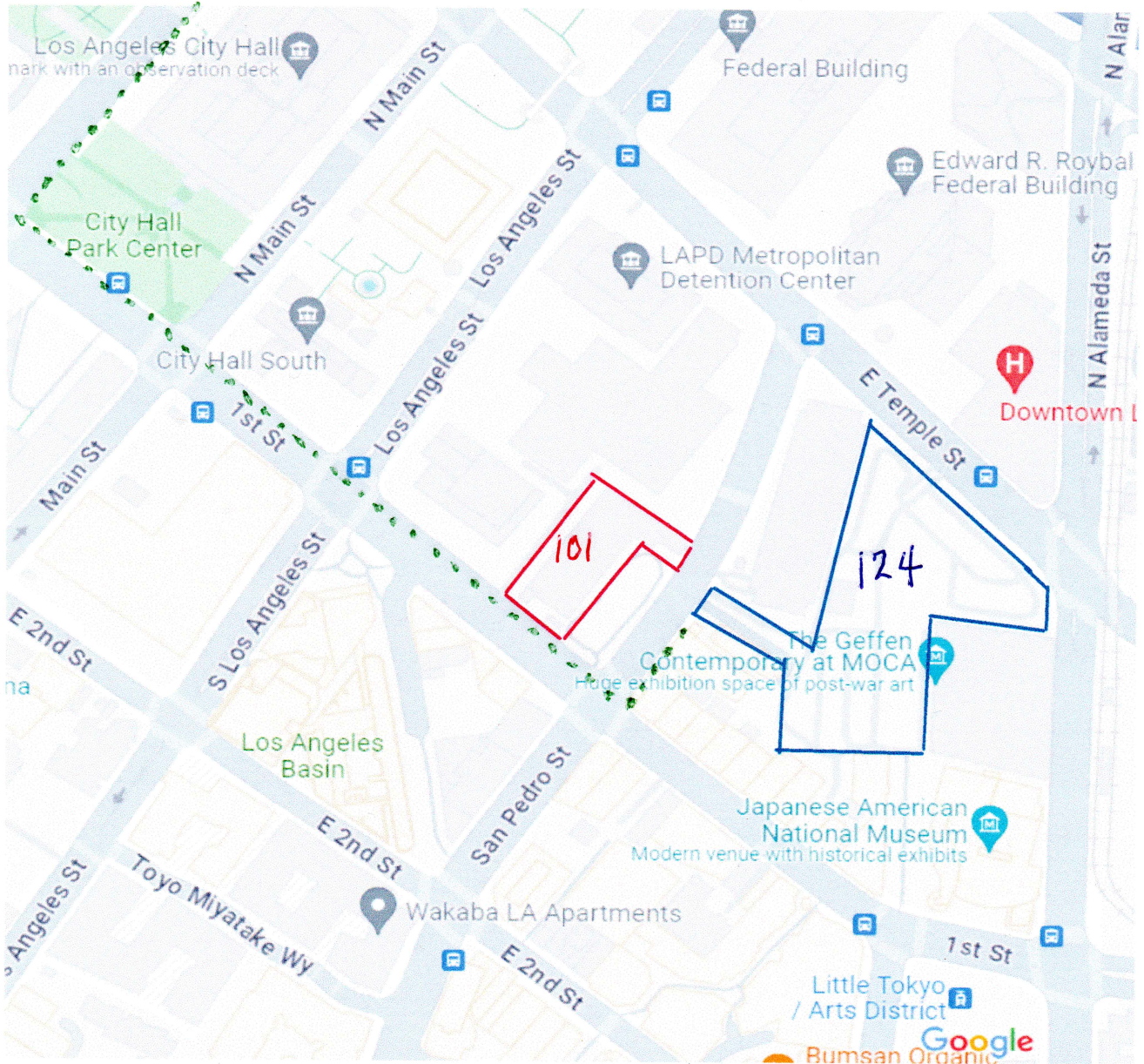

After exiting the parking lot go west on First Street to Spring Street. Turn right on Spring Street. (green dots) Go to the middle of the block and cross the street into Grand Park. Continue up the park to the Performance Lawn.